

Installation Guide

BELDEN Termination Station

BELDEN

Version 04.00 2007 PX103206

1/2 pages

The **Termination Station** secures a cable and a module during termination.

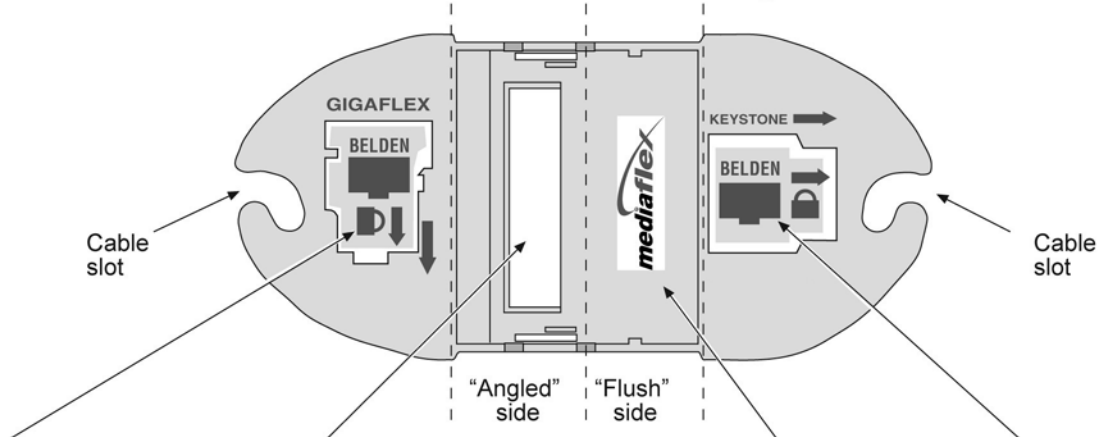

GigaFlex

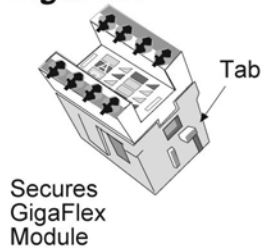

MediaFlex Inserts

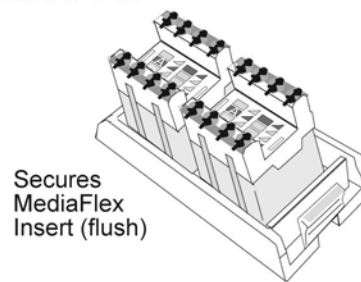
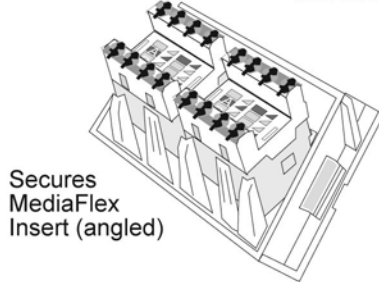

KEYSTONE



Note: Terminate the various modules using the appropriate Belden Installation Guides.

Securing a *GigaFlex* Module

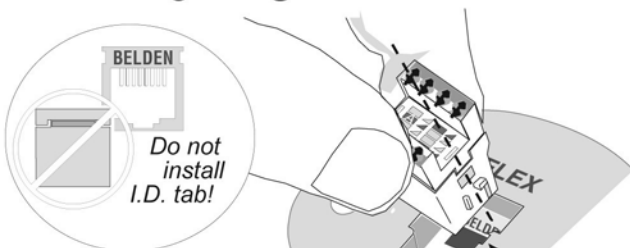

Hold module firmly with two fingers!

1. Align module under the word "GIGAFLEX"
2. Seat!

Note: Reverse sequence to unlock and remove the terminated module.

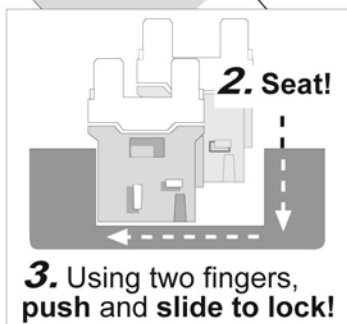

Securing a GigaFlex, *KEYSTONE*-style

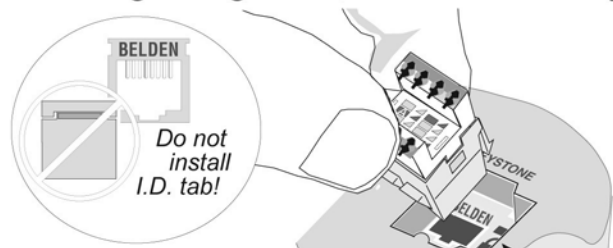

Hold module firmly with two fingers!

1. Center jack in station.
2. Seat!

Note: Reverse sequence to unlock and remove the terminated module.

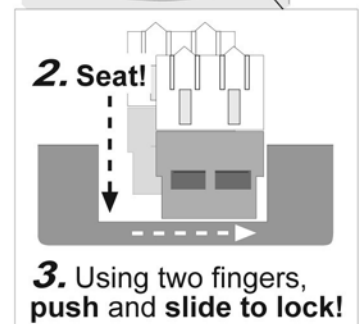

Securing an angled *MediaFlex* Insert

1. Position insert end in bottom of the “angled” side in the MediaFlex section.
2. Using a small-tip screwdriver, **Lever** termination station side-tab, outwards, while directing insert down into section until secure.

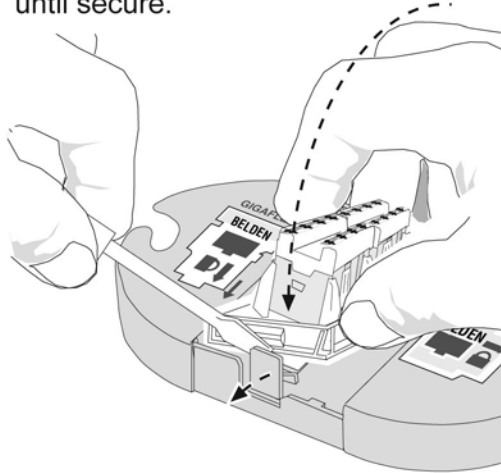

Releasing an angled *MediaFlex* Insert

1. Wedge small-tip screwdriver between side-tab, and terminated module assembly.

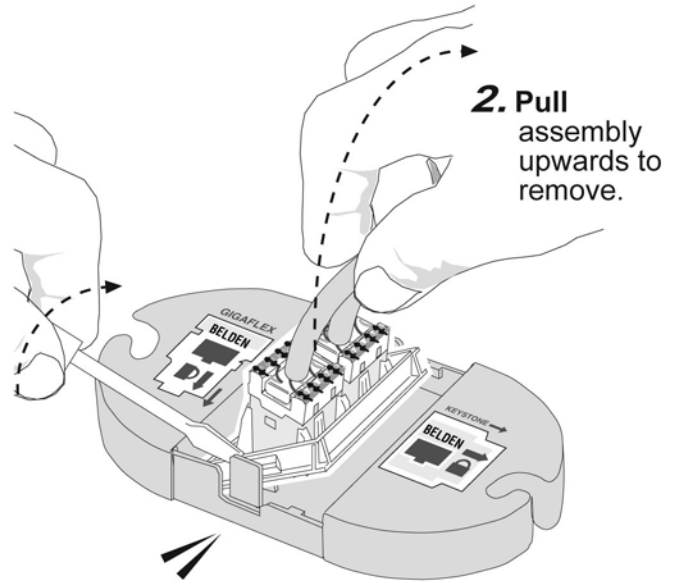

Securing a flush *MediaFlex* Insert

Position and direct insert, down into “flush” side of MediaFlex section until secure.

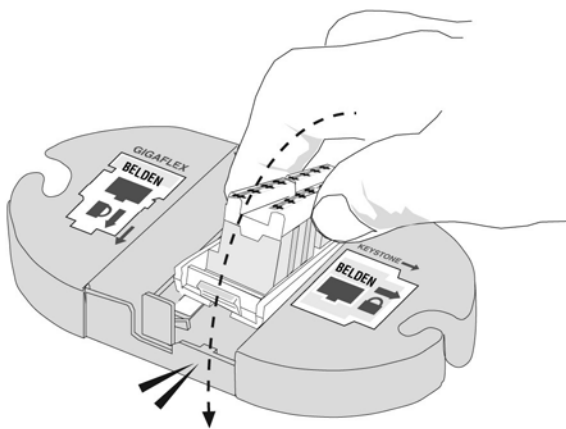

Releasing a flush *MediaFlex* Insert

1. Push tab on the side of the insert inwards with a small-tip screwdriver.

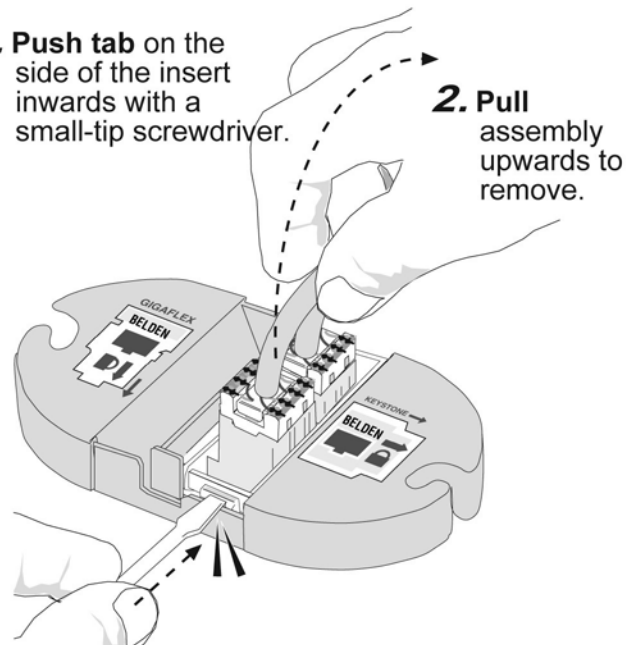

For additional technical information on the Termination Station or our other connecting products, call 1-800-858-7954

